

WC800-DM4 ATR Assembly Manual



Preparing the Motors

There is a brake on the wheelchair motors that we recommend be removed before assembly (the brake is turned on by default and if you run the motors with the brake on you will burn the motors up). There is also aluminum plate that needs to be removed. Follow these steps (If you selected to add encoders on the motors, the brake has already been removed. Skip to step 5.):

1. Remove the back cover of the motor



2. Remove the brake by taking out two screws.



3. Cut the two white wires. These are no longer used.



4. Cut the connector off of the motor and remove the two white wires by pulling them through the wire jacket.



5. Remove the six socket head screws holding the aluminum plate to the bottom of the motor. Remove the aluminum plate, it will not be used. Set the screws aside, these will be used to mount the motors to the chassis.

Mechanical Assembly

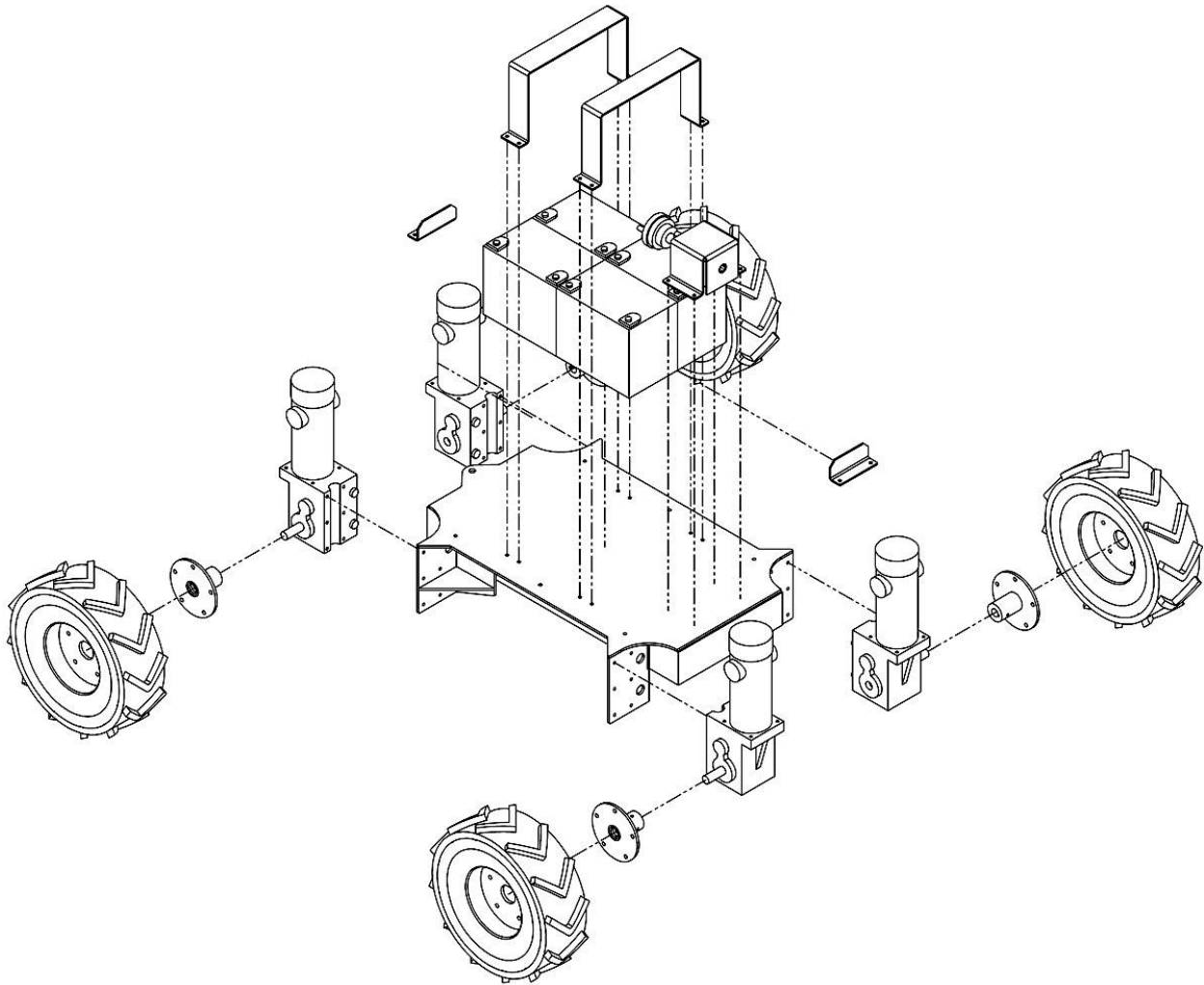

1. Mount motors using the socket head screws that came with the motors and washers that came with the kit.
2. Mount wheels to wheel hubs using the provided hardware. Be sure to align the tread pattern on each tire in the same direction. Slide wheel/hub assembly onto the motor shaft and fasten with the provided M8 screw into the end of the motor shaft and two set screws into the side of the motor shaft.
3. Mount batteries by using battery brackets and provided hardware.
4. Mount switch to switch bracket, then mount the bracket to the chassis by marking and drilling holes in the chassis and using provided hardware.
5. You are now done with the main mechanical assembly. For wiring, see the ATR and Vectoring Robots Manual and Wiring Big Electric Motors.