

# E2 Assembly Instructions

## Step 1:

Place the base over the shaft and onto the mounting surface. Slide the centering tool onto the shaft so that it contacts and aligns the base. While applying light pressure to the centering tool, secure the base to the mounting surface using two or three screws depending on bolt circle preference. Remove centering tool.

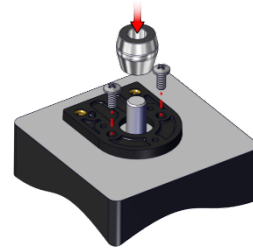

## Step 2:

Place spacer tool onto base and fit around shaft as shown. Orient the hubdisk so that the disk is between the set screw and encoder base. Slip hubdisk assembly onto shaft and apply pressure so it bottoms out against the spacer tool.



## Step 3:

While maintaining downward pressure on the hub tighten the set screw using the provided hex wrench.

Hub set screw:  
2-3 in-lbs torque

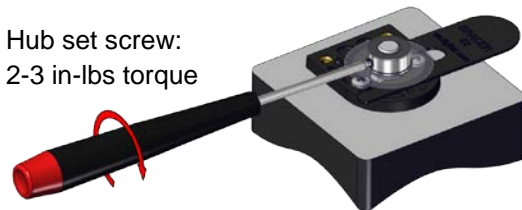

## Step 4:

Slip optical module into position so the two alignment pins slip into holes of module (thin side of module towards bottom).

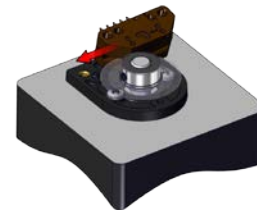

## Step 5:

Place housing (cover) over assembly and secure with two 4-40 screws (supplied).

Cover screws:  
2-4 in-lbs torque

