

**SUPERDROID ROBOTS INC**

Ph: 919-557-9162  
 Fax: 775-416-2595

**PROPRIETARY AND CONFIDENTIAL**

THE INFORMATION CONTAINED IN THIS DRAWING IS THE SOLE PROPERTY OF SUPERDROID ROBOTS INC. ANY REPRODUCTION IN PART OR AS A WHOLE WITHOUT THE WRITTEN PERMISSION OF SUPERDROID ROBOTS INC IS PROHIBITED.

UNLESS OTHERWISE SPECIFIED:  
 DIMENSIONS ARE IN INCHES  
 ANGULAR: 0.5 deg  
 TWO PLACE DECIMAL ±0.03  
 THREE PLACE DECIMAL ±0.005

COMMENTS:

Tracks, Wheels and Rollers are hidden to make viewing chassis easier

SIZE

**C**

DWG. NO.

HD2 Assembly Layout

REV

9/6/2010

SCALE: 1:5

MATERIAL:

SHEET 1 OF 2

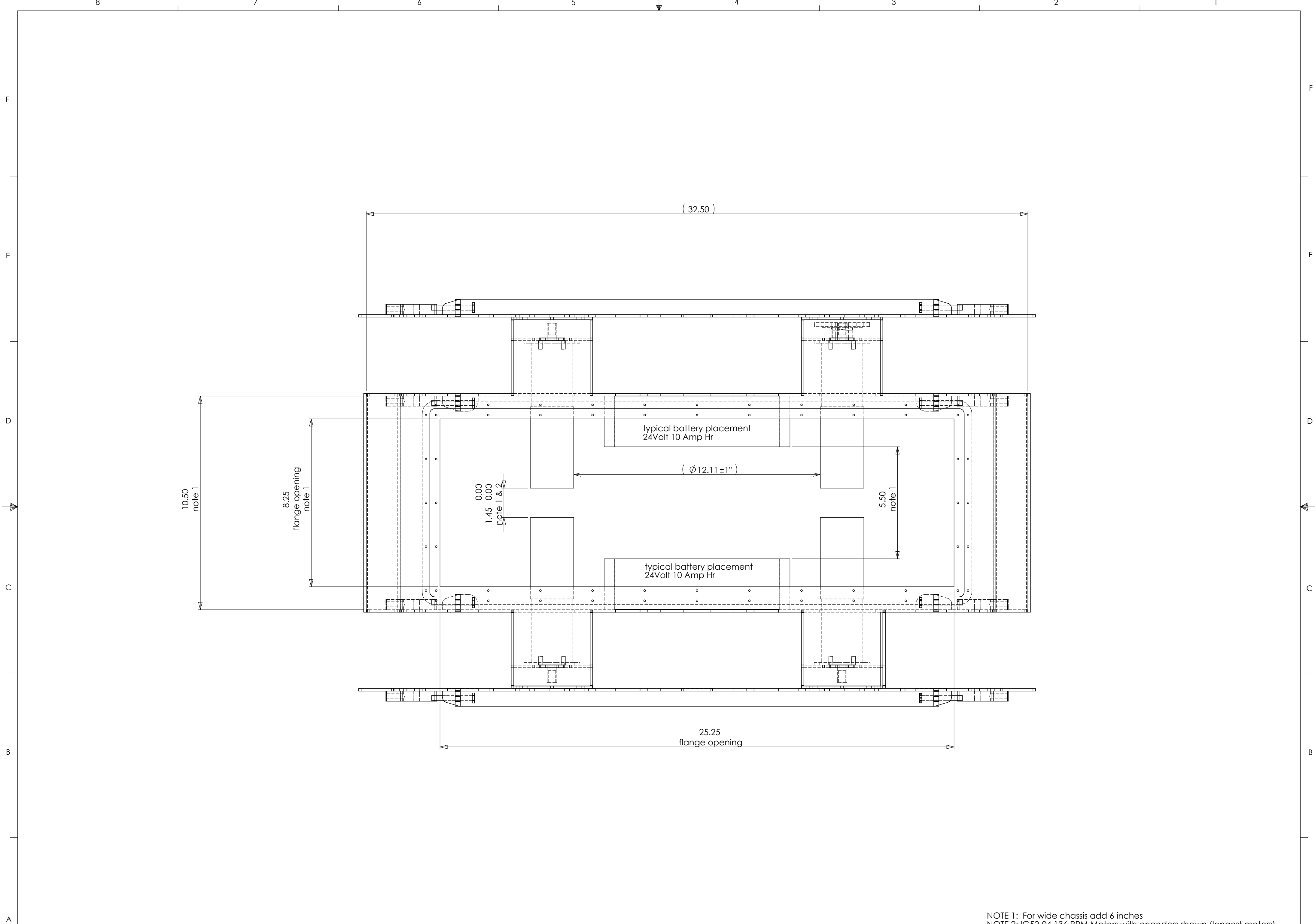

NOTE 1: For wide chassis add 6 inches  
 NOTE 2: IG52-04 136 RPM Motors with encoders shown (longest motors)

<b>SUPERDROID ROBOTS INC</b> Ph: 919-557-9162 Fax: 775-416-2595	<b>PROPRIETARY AND CONFIDENTIAL</b> THE INFORMATION CONTAINED IN THIS DRAWING IS THE SOLE PROPERTY OF SUPERDROID ROBOTS INC. ANY REPRODUCTION IN PART OR AS A WHOLE WITHOUT THE WRITTEN PERMISSION OF SUPERDROID ROBOTS INC IS PROHIBITED.	UNLESS OTHERWISE SPECIFIED: DIMENSIONS ARE IN INCHES ANGULAR: 0.5 deg TWO PLACE DECIMAL ±0.03 THREE PLACE DECIMAL ±0.005	COMMENTS: Tracks, Wheels and Rollers are hidden to make viewing chassis easier	SIZE <b>C</b>	DWG. NO. <b>HD2 Assembly Layout</b>	REV <b>9/6/2010</b>
				SCALE: 1:15	MATERIAL:	SHEET 2 OF 2