

PROPRIETARY AND CONFIDENTIAL

THE INFORMATION CONTAINED IN THIS DRAWING IS THE SOLE PROPERTY OF SUPERDROID ROBOTS INC. ANY REPRODUCTION IN PART OR AS A WHOLE WITHOUT THE WRITTEN PERMISSION OF SUPERDROID ROBOTS INC IS PROHIBITED.

UNLESS OTHERWISE SPECIFIED:
 DIMENSIONS ARE IN INCHES
 ANGULAR: 0.5 deg
 TWO PLACE DECIMAL ±0.03
 THREE PLACE DECIMAL ±0.005

SUPERDROID ROBOTS INC

Ph: 919-557-9162
 Fax: 775-416-2595

SIZE DWG. NO.
A 0211-050_SD5_Assy

REV
 10-18-2012

SCALE: 1:8 MATERIAL:

SHEET 1 OF 3

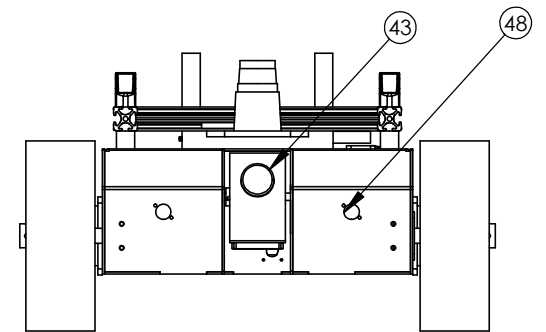
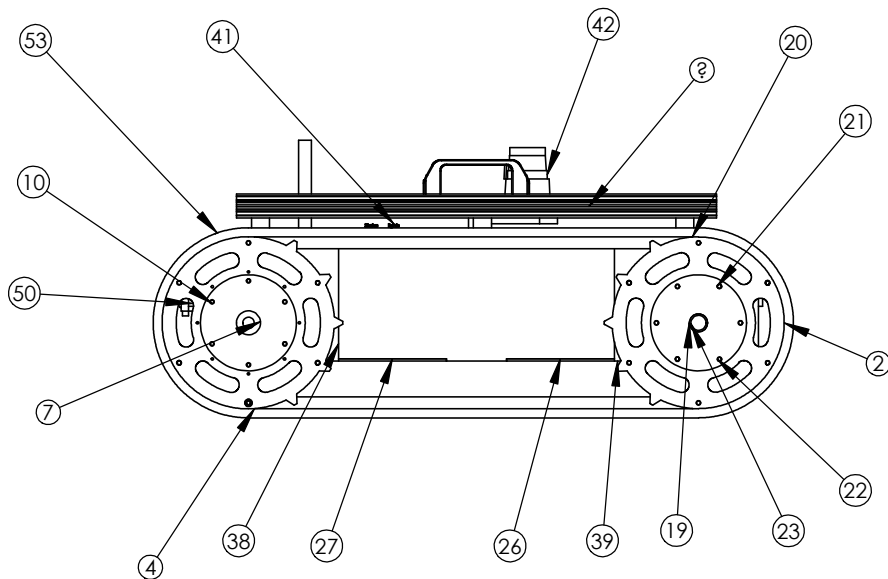
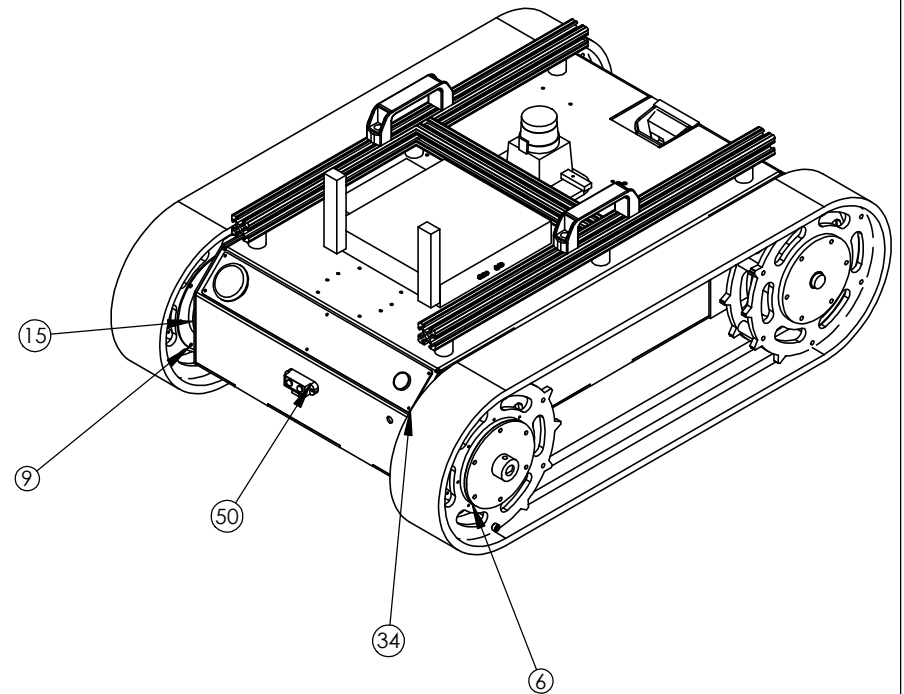
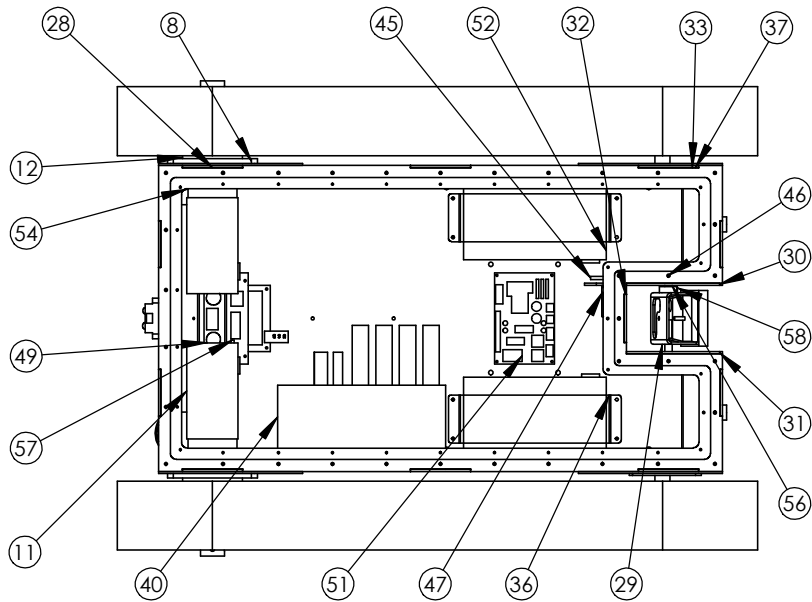

PROPRIETARY AND CONFIDENTIAL
 THE INFORMATION CONTAINED IN THIS DRAWING IS THE SOLE PROPERTY OF SUPERDROID ROBOTS INC. ANY REPRODUCTION IN PART OR AS A WHOLE WITHOUT THE WRITTEN PERMISSION OF SUPERDROID ROBOTS INC IS PROHIBITED.

UNLESS OTHERWISE SPECIFIED:
 DIMENSIONS ARE IN INCHES
 ANGULAR: 0.5 deg
 TWO PLACE DECIMAL ±0.03
 THREE PLACE DECIMAL ±0.005

SUPERDROID ROBOTS INC

Ph: 919-557-9162
 Fax: 775-416-2595

SIZE DWG. NO.
A 0211-050_SD5_Assy

REV
 5-11-11

SCALE: 1:8 MATERIAL:

SHEET 2 OF 3

ITEM NO.	PART NUMBER	DESCRIPTION	QTY.
1	0211-051_SD5_track_assy		2
2	SD5_tread		1
3	0211-053_SD5-drive-wheel-assy		1
4	0211-901_SD5_Drive_Wheel_TEETH		2
5	0211-002_SD5_IG52_Plate		1
6	0211-005_SD5_Wheel_motor_mount_spacer		1
7	0211-006_SD5_Motor_hub		1
8	0211-007_SD5_Wheel_Tube_Mount		1
9	0211-903_SD5_bearing_seal		1
10	0211-905_SD5_Drive_Wheel_Center_Hub		1
11	IG52gm gearmotor_82RPM_ENC	standard motor hookup kit ferrites and heat shrink	1
12	ig52_motor_tube		1
13	wheel_spacer_94639A406		6
14	bearing_2x3x.25_VA025CP0		1
15	shaft_seal_2.5_9562K53		1
16	91251A342		2
17	0211-052_SD5-tensioner-wheel-assy		1
18	tensioner shaft collar		1
19	bearing sleeve_2938T18		2
20	0211-902_SD5_tension_Wheel_TEETH		2
21	0211-720_SD5_tension_wheel_retainer		2
22	wheel_spacer_94639A406		12
23	tension shaft		1
24	0211-906_SD5_Tensioning_Block		1
25	0211-907_SD5_Tension_jack_plate		1
26	0211-008_SD5_Chassis		1
27	0211-009_SD5_bottom		1
28	0211-010_SD5_bottom_flange		1
29	0211-715_SD5_Camera_Bracket		1
30	0211-716_Camera_housing_servo_side		1
31	0211-717_Camera_housing_side		1
32	0211-718_Camera_housing_back		1
33	0211-906_SD5_Tensioning_Block		2
34	0211-726_engraved_back_panel		1
35	0211-729_Router_wire_cover		1
36	0211-730_battery_mount		2
37	0211-907_SD5_Tension_jack_plate		2
38	0211-908_SD5_Rear_Gusset		2
39	0211-909_SD5_Front_Gusset		2
40	CRIO	National Instruments	1
41	Router_buffalo_WZR-HP-G300NH		1
42	Laser_scanner_URG-04LX-UG01		1
43	camera_axis_m1011		1
44	clamping_hub_3166CH	servo city	1
45	servo_gear_RSA32-2HS-56	servo city	1
46	spur_gear_RHA32-36-96	servo city	1
47	servo	Hitec 422	1
48	EZ1_sonar		2
49	motor_controller_Roboteq_2X20_SDC2130		1
50	sensor - IR-Sharp-GP2D12		1
51	power_board		1
52	Battery_SLA-12V12	12 volt 12 amp hour	2
53	E-Stop		1
54	switch_illuminated_6886K53		1
55	washer_5-16_90295A461		4
56	spacer_brass_5-16_90309A778		2
57	Encoder_board		1
58	camera_tilt_lock_collar		1
59	47065T123		2
60	47065T164		2
61	92825A146		6
62	47065T123		1
63	0211-015_Lidar_Bracket		1

SUPERDROID ROBOTS INC

Ph: 919-557-9162
Fax: 775-416-2595

PROPRIETARY AND CONFIDENTIAL

THE INFORMATION CONTAINED IN THIS DRAWING IS THE SOLE PROPERTY OF SUPERDROID ROBOTS INC. ANY REPRODUCTION IN PART OR AS A WHOLE WITHOUT THE WRITTEN PERMISSION OF SUPERDROID ROBOTS INC IS PROHIBITED.

UNLESS OTHERWISE SPECIFIED:
DIMENSIONS ARE IN INCHES
ANGULAR: 0.5 deg
TWO PLACE DECIMAL ±0.03
THREE PLACE DECIMAL ±0.005

SIZE

A

DWG. NO.

0211-050_SD5_Assy

REV

5-11-11

SCALE: 1:14

MATERIAL:

SHEET 3 OF 3